

OWNER'S STATEMENT

I. I HEREBY STATE THAT I AM THE OWNER OF, OR HAVE SOME RIGHT TITLE OR INTEREST IN AND TO THE REAL PROPERTY INCLUDED WITHIN THE SUBDIVISION SHOWN UPON THIS MAP; AND I AM THE ONLY PERSON WHOSE CONSENT IS NECESSARY TO PASS CLEAR TITLE TO SAID PROPERTY; AND I HEREBY CONSENT TO THE MAKING AND FILING OF SAID MAP AND SUBDIVISION AS SHOWN WITHIN THE DISTINCTIVE BORDER LINE.

II. I ALSO HEREBY DEDICATE A 10' WIDE PUBLIC FACILITY EASEMENTS (PFE) AND PRIVATE STORM DRAIN EASEMENTS (PSDE) AS DELINEATED ON THIS MAP FOR THE BENEFIT OF LOTS 1 THROUGH 5.

BY:

Stan Gamble
STAN GAMBLE, TRAFALGAR, INC. PRESIDENT

OWNER'S ACKNOWLEDGMENT

STATE OF CALIFORNIA)

Santa Clara
COUNTY OF AMADOR)

ON November 29, 2004, BEFORE ME, THE UNDERSIGNED NOTARY PUBLIC, PERSONALLY

APPEARED Stan Gamble PERSONALLY KNOWN TO ME (OR PROVED TO ME ON THE BASIS OF SATISFACTORY EVIDENCE) TO BE THE PERSON(S) WHOSE NAME(S) IS/ARE SUBSCRIBED TO THE WITHIN INSTRUMENT AND ACKNOWLEDGED TO ME THAT HE/SHE/THEY EXECUTED THE NAME IN HIS/HER/THEIR AUTHORIZED CAPACITY(IES) AND THAT BY HIS/HER/THEIR SIGNATURE(S), ON THAT INSTRUMENT THE PERSON(S), OR THE ENTITY UPON BEHALF OF WHICH THE PERSON(S) ACTED, EXECUTED THE INSTRUMENT.

WITNESS BY MY HAND

MY COMMISSION EXPIRES: 11/11/06

Ashley Dumont
NOTARY SIGNATURE
NOTARY PUBLIC IN AND FOR THE
COUNTY OF Santa Barbara
STATE OF CALIFORNIA.

Ashley Dumont
PRINT NAME HERE
1384288
COMMISSION NUMBER

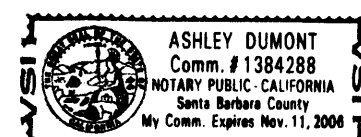

CITY ENGINEER'S STATEMENT

I HEREBY STATE THAT I HAVE EXAMINED THIS MAP AND THAT THE SUBDIVISION AS SHOWN HEREON IS SUBSTANTIALLY THE SAME AS IT APPEARED ON THE TENTATIVE MAP AND ANY APPROVED ALTERATIONS THEREOF; THAT ALL PROVISIONS OF THE CALIFORNIA "SUBDIVISION MAP ACT" AND OF LOCAL ORDINANCES APPLICABLE AT THE TIME OF APPROVAL OF THE TENTATIVE MAP HAVE BEEN COMPLIED WITH, AND THAT THIS MAP IS TECHNICALLY CORRECT.

Roark Weber 2/28/2005
ROARK WEBER R.C.E. 22295 EXPIRES 2-28-05 DATE
CITY ENGINEER
CITY OF SUTTER CREEK

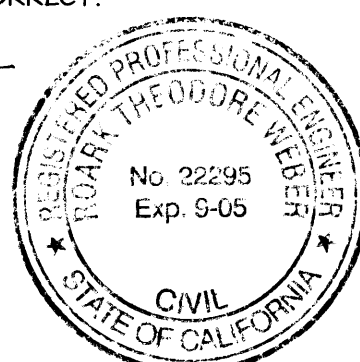

SURVEYOR'S STATEMENT

THIS MAP WAS PREPARED BY ME OR UNDER MY DIRECTION AT THE REQUEST OF STAN GAMBLE ON 05/16/2003 AND IS BASED UPON A FIELD SURVEY IN CONFORMANCE WITH REQUIREMENTS OF THE SUBDIVISION MAP ACT AND LOCAL ORDINANCE. I HEREBY STATE THAT THIS MAP SUBSTANTIALLY CONFORMS TO THE APPROVED OR CONDITIONALLY APPROVED TENTATIVE MAP, AND THAT ALL MONUMENTS ARE OF THE CHARACTER AND WILL BE SET IN THE POSITIONS INDICATED ON OR BEFORE DECEMBER 30, 2003 AND WILL BE SUFFICIENT TO ENABLE THE SURVEY TO BE RETRACED.

Edward M. Giuliani 11-15-04
EDWARD M. GIULIANI, L.S. 5907 EXP. 12-31-04 DATE

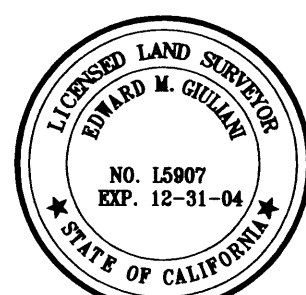

TRUSTEE'S STATEMENT

FIRST AMERICAN TITLE INSURANCE COMPANY, A CALIFORNIA CORPORATION, TRUSTEE UNDER DEED(S) OF TRUST RECORDED AUGUST 21, 2002 AS DOCUMENT NO. 2002-009963 AND JUNE 18, 2003 AS DOCUMENT NO. 2003-009077, OF OFFICIAL RECORDS

FIRST AMERICAN TITLE INSURANCE COMPANY, A CALIFORNIA CORPORATION

BY: _____

TRUSTEE'S ACKNOWLEDGMENT

STATE OF CALIFORNIA)

COUNTY OF AMADOR)

ON _____, 2004, BEFORE ME, PERSONALLY

APPEARED _____ PERSONALLY KNOWN TO ME (OR PROVED TO ME ON THE BASIS OF SATISFACTORY EVIDENCE) TO BE THE PERSON(S) WHOSE NAME(S) IS/ARE SUBSCRIBED TO THE WITHIN INSTRUMENT AND ACKNOWLEDGED TO ME THAT HE/SHE/THEY EXECUTED THE NAME IN HIS/HER/THEIR AUTHORIZED CAPACITY(IES) AND THAT BY HIS/HER/THEIR SIGNATURE(S), ON THAT INSTRUMENT THE PERSON(S), OR THE ENTITY UPON BEHALF OF WHICH THE PERSON(S) ACTED, EXECUTED THE INSTRUMENT.

WITNESS BY MY HAND
MY COMMISSION EXPIRES: _____

NOTARY PUBLIC IN AND FOR THE
COUNTY OF _____
STATE OF CALIFORNIA.

PRINT NAME HERE

COMMISSION NUMBER

TRUSTEE'S STATEMENT

GREATER BAY BANK, N.A., TRUSTEE UNDER DEED OF TRUST RECORDED JULY 12, 2004 AS DOCUMENT NO. 2004-009656, OF OFFICIAL RECORDS

GREATER BAY BANK, N.A.

BY: Cecilia Fu
CECILIA FU, GREATER BAY BANK, N.A. - Authorized Signar

TRUSTEE'S ACKNOWLEDGMENT

STATE OF CALIFORNIA)

Santa Clara
COUNTY OF AMADOR)

ON November 29, 2004, BEFORE ME, THE UNDERSIGNED NOTARY PUBLIC, PERSONALLY

APPEARED Cecilia Fu PERSONALLY KNOWN TO ME (OR PROVED TO ME ON THE BASIS OF SATISFACTORY EVIDENCE) TO BE THE PERSON(S) WHOSE NAME(S) IS/ARE SUBSCRIBED TO THE WITHIN INSTRUMENT AND ACKNOWLEDGED TO ME THAT HE/SHE/THEY EXECUTED THE NAME IN HIS/HER/THEIR AUTHORIZED CAPACITY(IES) AND THAT BY HIS/HER/THEIR SIGNATURE(S), ON THAT INSTRUMENT THE PERSON(S), OR THE ENTITY UPON BEHALF OF WHICH THE PERSON(S) ACTED, EXECUTED THE INSTRUMENT.

WITNESS BY MY HAND

MY COMMISSION EXPIRES: August 10, 2007

Patricia Lam
NOTARY SIGNATURE
NOTARY PUBLIC IN AND FOR THE
COUNTY OF Santa Clara
STATE OF CALIFORNIA.

Patricia Lam
PRINT NAME HERE

1434290
COMMISSION NUMBER

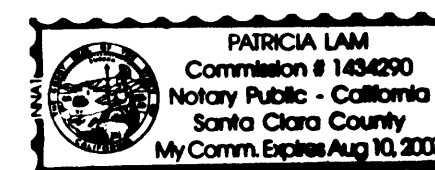

CITY ATTORNEY'S STATEMENT

I, J. DENNIS CRABB, HEREBY APPROVE OF THE LANGUAGE SET FORTH ON THIS MAP.

J. Dennis Crabb 3/7/05
J. DENNIS CRABB, CITY ATTORNEY, CITY OF SUTTER CREEK DATE

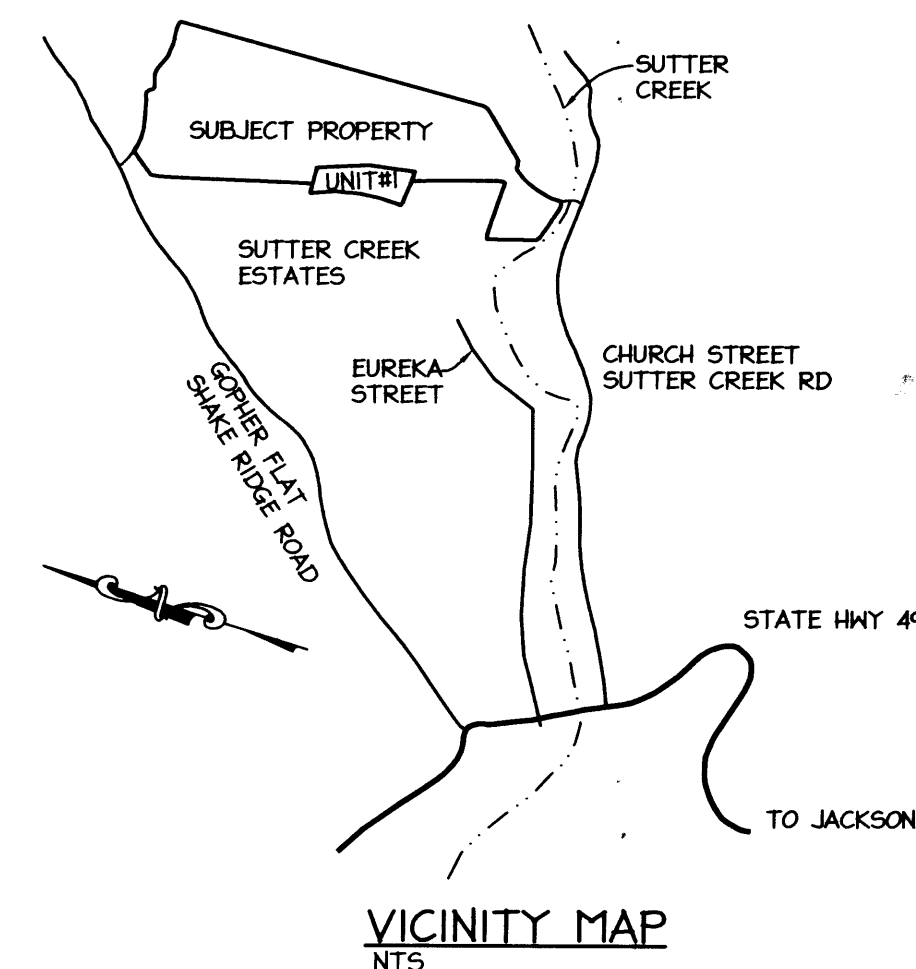

CITY CLERK'S STATEMENT

ALL OFFERS OF DEDICATION FOR PUBLIC FACILITY EASEMENTS THAT APPEAR ON THIS MAP WERE ACCEPTED BY THE CITY COUNCIL ON 12-20-2004 BY RESOLUTION NO. 04-05-10. ALL OTHER OFFERS OF DEDICATION WERE REJECTED.

Judy Allen 3-10-05
JUDY ALLEN, CITY CLERK, CITY OF SUTTER CREEK DATE

COUNTY RECORDER'S STATEMENT

FILED THIS 3rd DAY OF June, 2005, AT 1:27 PM IN BOOK 8 OF SUBDIVISIONS AT PAGES 36 AND 40, AT THE REQUEST OF THE CITY CLERK. THRU

INST. NO. 20050006816 CERT. NO. 956

FEE: \$ 30.00 pd. + filed

SHELDON D. JOHNSON, COUNTY RECORDER

BY: Kim Grady
DEPUTY RECORDER

SUBDIVISION MAP NO. 133
GOLDEN HILLS ESTATES
UNIT ONE

BEING A PORTION OF SECTIONS 5 AND 8, T.6N, R.11E., M.D.M. AND PARCEL B AS SHOWN ON THAT OFFICIAL SUBDIVISION MAP RECORDED IN BOOK 5, PAGE 82.

CITY OF SUTTER CREEK
AMADOR COUNTY, CALIF.

NOVEMBER, 2004

GK Giuliani & Kull, Inc.
Engineers • Planners • Surveyors

11899 Edgewood Road, Suite Q, Auburn, CA 95603
(530) 885-5107 Fax (530) 885-5157

Auburn • San Jose • Oakdale

SHEET 1 OF 5