

LEGEND

- EXISTING MONUMENTS -----
- CONCRETE MONUMENTS WITH CAST IRON
FRAME AND COVER TO BE INSTALLED -----
- PUE = PUBLIC UTILITY EASEMENT
- PE = PLANTING EASEMENT

BUILDING SET-BACK LINES

BUILDING SET-BACK LINES TO BE AS
REQUIRED BY THE ZONING ORDINANCE
OF THE CITY OF FREMONT AS MODIFIED
BY PUD 64-4, DATED 4/20/64.

BASIS OF BEARINGS

MONUMENT LINE ON DRISCOLL ROAD
TAKEN AS N36°00'00"E

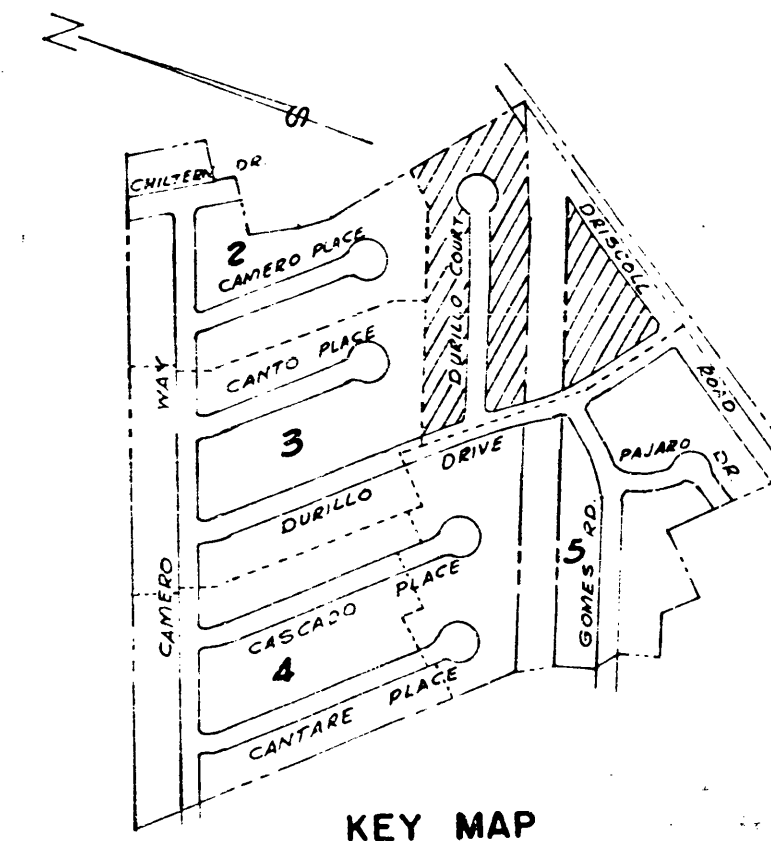

KEY MAP

This is a copy of a map on file in the Recorder's Office
of Alameda County. No representation of any kind is made
as to the accuracy of the original official map from which
this is copied, and this copy carries with it no representa-
tion of any kind other than that it is a copy.

Any questions concerning this map should be directed
to the Recorder's Office of Alameda County.
METEORIC POST COMPANY

TRACT 2664

CITY OF FREMONT
ALAMEDA COUNTY, CALIFORNIA
SCALE 1" = 40' OCTOBER, 1964

MURRAY & Mc CORMICK, INC.
CONSULTING CIVIL ENGINEERS
SAN LEANDRO CALIFORNIA

SHEET 6 OF 6 SHEETS

GRAPHIC SCALE IN FEET

461

AX 42318 FILED MARCH 30, 1965 BOOK 50, PAGES 970-11