

CORNER RECORD

Agency Index

BK 114 PG 2

Document Number

CR 11713

City of EDEN TOWNSHIP

County of

ALAMEDA

, California

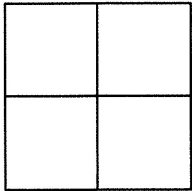
Brief Legal Description WELL MONUMENT LOCATED WITHIN KELLY ST
AT THE INTERSECTION OF WOODROE AVE

CORNER TYPE

Government Corner ☐ Control ☒
Meander ☐ Property ☐
Rancho ☐ Other ☐Date of Survey 6/25/18

COORDINATES (Optional)

N. 2075449 ± E. 6111818 ±

Elevation

Units Metric ☐ U.S. Survey Foot ☐

Horizontal Datum

Zone Epoch Date

Vertical Datum

☐ Complies with Public Resources Code §§8801-8819☐ Complies with Public Resources Code §§8890-8902PLS Act Ref: ☐ 8765(d)☒ 8771☐ 8773☐ Other:Corner/
Monument: ☒ Left as found☐ Established☐ Rebuilt☒ Pre-Construction☐ Found and tagged☐ Reestablished☒ Referenced☐ Post-Construction

Narrative of corner identified and monument as found, set, reset, replaced, or removed:

☐ See sheet #2 for description(s) :

MONUMENT DILIGENTLY SEARCHED FOR BUT NOT FOUND

SURVEYOR'S STATEMENT

This Corner Record was prepared by me or under my direction in conformance with

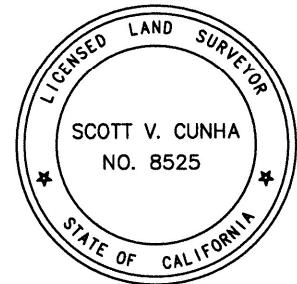
the Professional Land Surveyors' Act on JUNE 29, 2018.Signed Scott V Cunha P.L.S. or R.C.E. No. LS 8525
SCOTT V. CUNHA

COUNTY SURVEYOR'S STATEMENT

This Corner Record was received 3 JULY 2018and examined and filed 13 SEPTEMBER 2018Signed Michael Rubner P.L.S. or R.C.E. No. 6843Title COUNTY SURVEYOR

County Surveyor's Comment

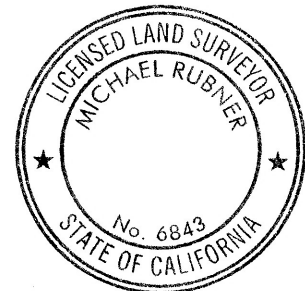

SPEC-2356-Pre

SCALE: 1"=30'

LEGEND

⊙ MONUMENT SEARCHED FOR BUT NOT FOUND

AA### ALAMEDA COUNTY MONUMENT ID

19592 REFERENCE STREET ADDRESS

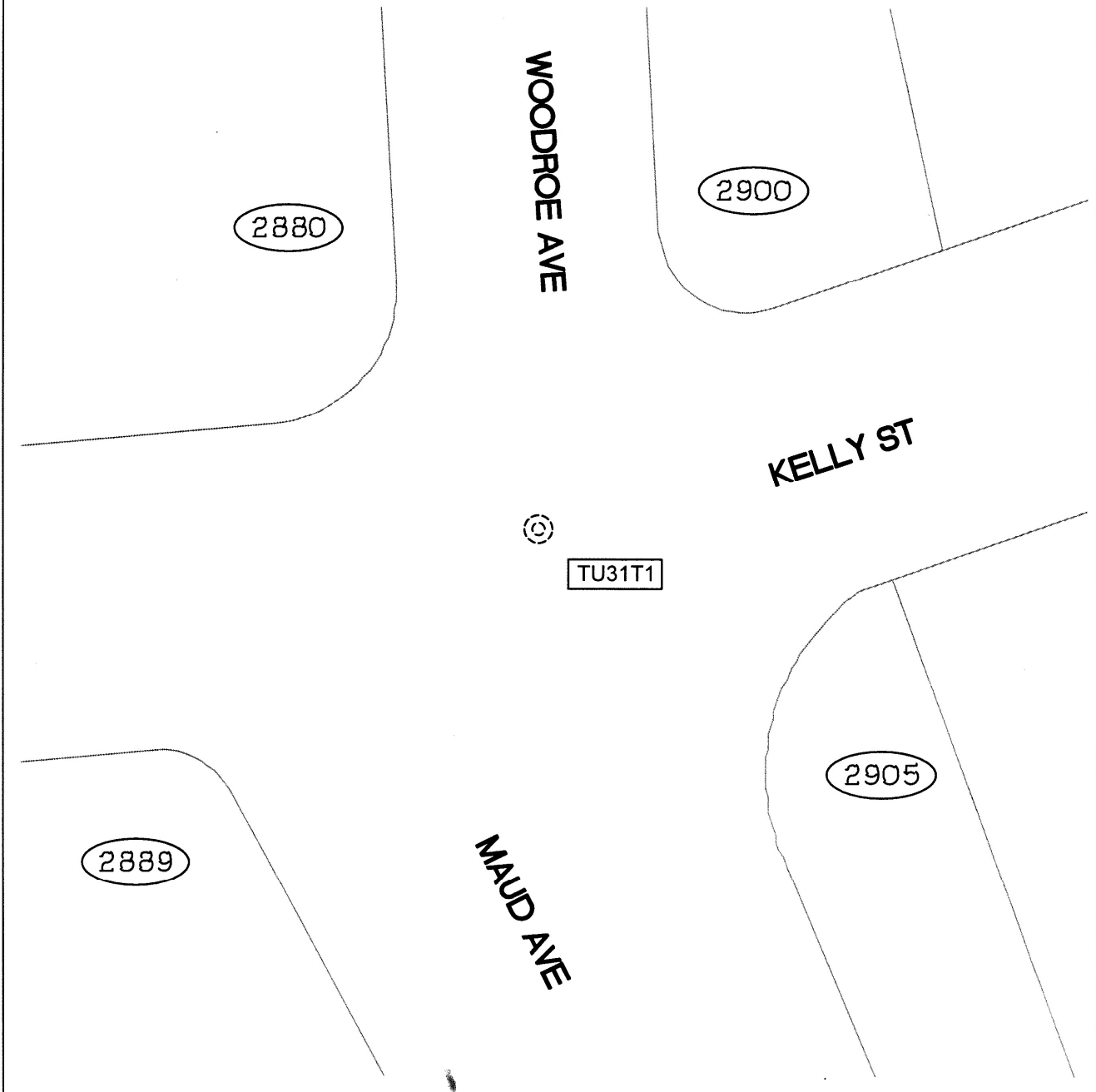

218070-Woodroe-CR-12