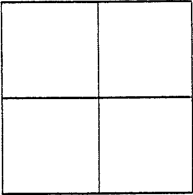

## CORNER RECORD

Document Number CR 3709City of OAKLANDCounty of ALAMEDA, CaliforniaBrief Legal Description BRASS DISC IN MONUMENT WELL LOCATED WITHIN THE INTERSECTION OF  
MACARTHUR BOULEVARD AND PALM VILLA COURT.

## CORNER RECORD

Government Corner ☐ Control ☒  
 Meander ☐ Property ☐  
 Rancho ☐ Other ☐  
 Date of Survey 03/25/09

COORDINATES  
(Optional)

N. \_\_\_\_\_  
 E. \_\_\_\_\_  
 Zone \_\_\_\_\_ Datum \_\_\_\_\_  
 Elev. \_\_\_\_\_

Corner — Left as found ☒ Found and tagged ☐ Established ☐ Reestablished ☐ Rebuilt ☐

Identification and type of corner found: Evidence used to identify or procedure used to establish or reestablish the corner:  
FOUND BRASS DISC IN MONUMENT WELL LOCATED WITHIN THE INTERSECTION OF MACARTHUR  
 BOULEVARD AND PALM VILLA COURT.

(NOTE: NO MONUMENT SHOWN AT SUBJECT LOCATION PER CITY OF OAKLAND  
 MONUMENT MAP.)

THIS POINT WAS REFERENCED PRIOR TO A CONSTRUCTION PROJECT IN THE VICINITY.

A description of the physical condition of the monument as found and as set or reset:  
FOUND AND SET POINTS AS SHOWN ON PAGE 2.

## SURVEYOR'S STATEMENT

This Corner Record was prepared by me or under my direction in conformance with  
 the Land Surveyors' Act on MARCH 26, 2009.  
 Signed Vincent H. Cunha L.S. Number LS 4520  
VINCENT H. CUNHA



## COUNTY SURVEYOR'S STATEMENT

This Corner Record was received 60-16- 2009 and examined  
 and filed 8-13- 2009.  
 Signed Russell R. Penland Title COUNTY SURVEYOR

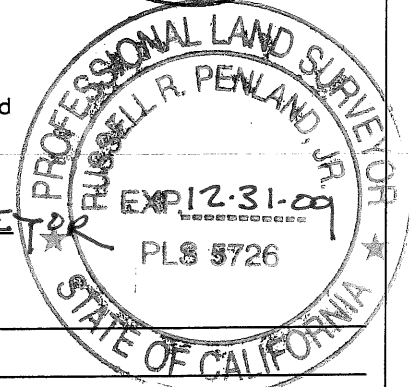

County Surveyor's Comment \_\_\_\_\_

  
 SCALE : 1"=40'

LEGEND

- FOUND BRASS DISC IN MONUMENT WELL
- ⊗ SET NAIL AND TAG LS 4520

