

*Township N° 7 North, Range N° 15 East, Mount Diablo Meridian.*

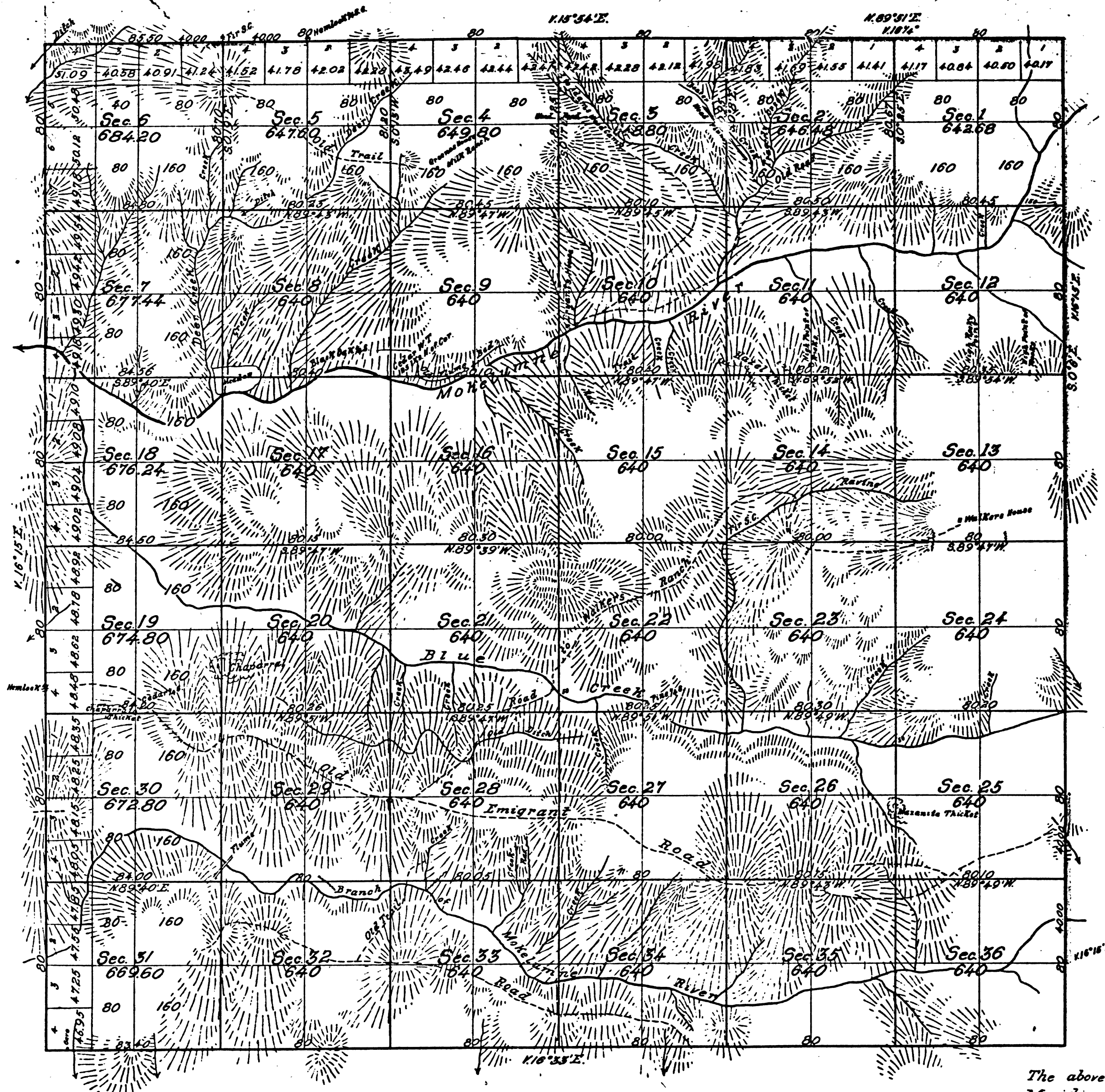

*Aggregate Area of Public Land 23,290.44 Acres*

*Transmitted for filing in Register's Office at  
Sacramento Jan. 28, 1876*

DEPARTMENT OF THE INTERIOR,  
GENERAL LAND OFFICE,  
Washington, D. C. *Sept. 6, 1897.*  
I hereby certify that this is a true copy  
of the plat of official survey of the lands  
to which it relates, on file in this office.

*H. M. S. J. J. J.*  
Recorder, General Land Office.

Variation reported on Section lines 16°15'E.

*The above Map of Township N<sup>o</sup> 7 North, Range N<sup>o</sup> 15 East, Mount Diablo Meridian is strictly conformable to the field notes of the surveys thereof on file in this Office, which have been examined and approved.*  
*Surveyor General's Office,*  
*San Francisco California*  
*January 28<sup>th</sup> 1876.*

*Surv. Genl Cal.*

<i>Surveys Designated</i>	<i>By Whomsurveyed</i>	<i>Date of Contract</i>	<i>Amount of Surveys</i>	<i>When Surveyed.</i>
<i>Township lines</i>	<i>D. F. Douglass</i>	<i>October 19<sup>th</sup> 1859</i>		<i>1859</i>
<i>" " colored brown</i>	<i>J. M. Anderson</i>	<i>June 25<sup>th</sup> 1815</i>	<i>8 mls 00chs. 00lks</i>	<i>1815</i>
<i>Section lines</i>	<i>" " "</i>	<i>" " "</i>	<i>60 " 31 " 96 "</i>	<i>July 21<sup>st</sup> 1875.</i>

41 611

**T 7 N R 1 E M D.**

BLM 323