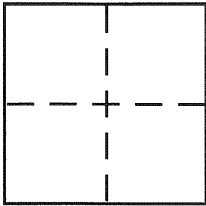

CORNER RECORDDocument Number CR 1665
City of BERKELEY County of ALAMEDA, CaliforniaBrief Legal Description MONUMENT AT GILMAN STREET AND EIGHTH STREET**CORNER TYPE**

Government Corner ☐ Control ☐
 Meander ☐ Property ☐
 Rancho ☐ Other ☐
 Date of Survey OCT 28 2001

COORDINATES (Optional)

N. _____
 E. _____
 Zone _____ NAD27 ☐ NAD83 ☐
 NAD83 Epoch _____
 Elev. _____
 Vert. Datum: NGVD29 ☐ NAVD88 ☐
 Meas. Units: Metric ☐ Imperial ☐

Corner – Left as found ☒ Found and tagged ☐ Established ☐ Reestablished ☐ Rebuilt ☐

Identification and type of corner found: Evidence used to identify or procedure used to establish or reestablish the corner:

MONUMENT NO MAP SEE ASSESSOR'S MAP 60 BK 6
Pg 16 BK 60 Pg 2350
TIED OUT AND LEFT AS FOUND

A description of the physical condition of the monument as found and as set or reset:

NAIL IN CONCRETE POST (NO TAG) IN MONUMENT CASING,
LEFT AS FOUND

SURVEYOR'S STATEMENT

This Corner Record was prepared by me or under my direction in conformance with the Land Surveyor's Act on JAN 28 2002

Signed DAVE KORYCINSKI P.L.S or R.C.E. No. 6811

COUNTY SURVEYOR'S STATEMENT

This Corner Record was received 3.21.02
 and examined and filed 5.29.02

Signed Russell R. Penland, Jr. P.L.S or R.C.E. No. 5726

Title COUNTY SURVEYOR

County Surveyor's Comment _____

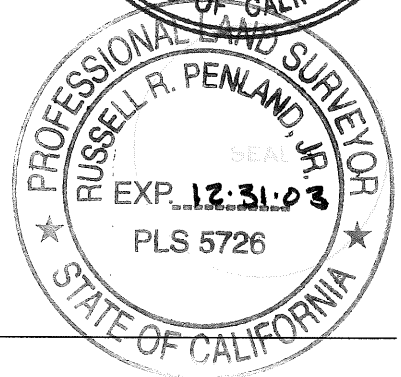
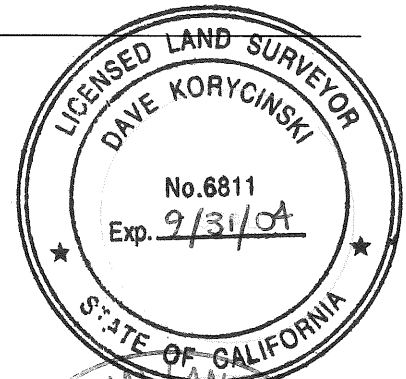

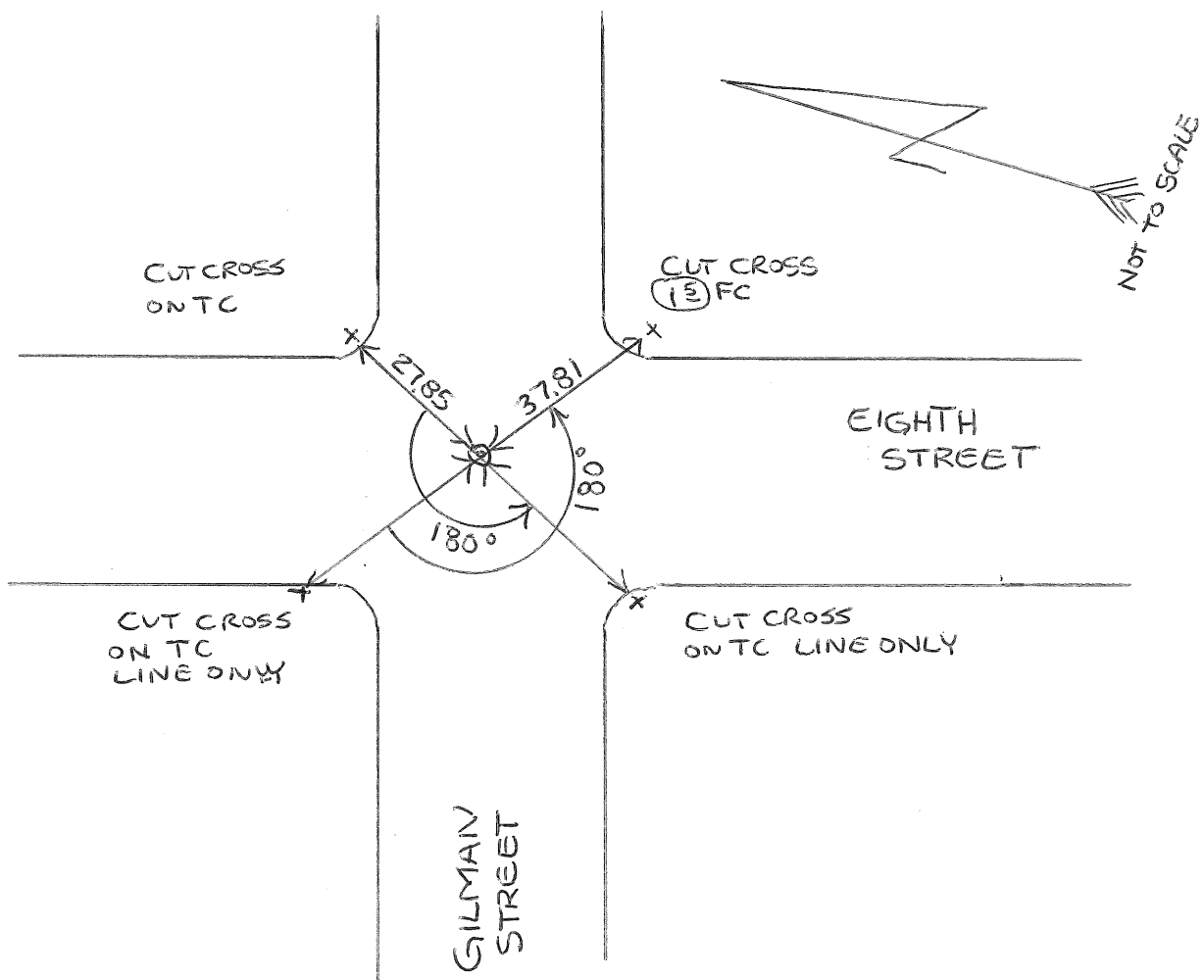

⊙ MONUMENT

+ CUT CROSS

TC TOP of CURB

FC FACE of CURB